



AP MORGAN

John Street, Stourbridge, West Midlands
Offers in excess of £220,000

Features:

- Two bedroom terrace
- Period property
- Cellar
- Lounge/diner
- Kitchen
- Contemporary bathroom
- Large garden
- EPC - D

Description:

Presenting this mid-1800s period property, brimming with original features, a cellar, and an expansive garden.

Inside, the property is a lounge diner adorned with ceiling beams, a gas log-burning stove, and a delightful arched window offering views of the rear porch and garden. There's convenient access to the cellar via the lounge/diner. The kitchen features integrated appliances and provides access to the rear porch, garden, and conservatory. Upstairs, there are two double bedrooms, along with a contemporary fitted bathroom with a bath and a separate double shower cubicle.

Externally, the front offers on-street parking options and a small gated entrance. The rear showcases a low-maintenance expansive garden with a fire pit area, brick-built BBQ stove, and a large garden store.

Situated close to the Stourbridge Glass Museum, this area is full of history, conveniently located 1.8 miles from Stourbridge Town Centre offering amenities and a train station providing access links to Worcester and Birmingham city centre. Additionally, it's just 0.3 miles from the nearest primary school and a mere 2 miles from the serene countryside walks at Kingsway Woods and Wordsley Waterfall.



Details:

Lounge/Diner 26'10" x 13'1" (max) (8.18m x 4m (max))

Kitchen 15'8" x 7'7" (4.78m x 2.3m)

Conservatory 9'6" x 6'9" (2.9m x 2.06m)

Cellar 11'2" x 12'4" (3.4m x 3.76m)

First Floor Landing

Master Bedroom 13'10" x 13'6" (max) (4.22m x 4.11m (max))

Bedroom Two 9'11" x 10'2" (3.02m x 3.1m)

Bathroom 9'9" x 7'4" (2.97m x 2.24m)



EPC Rating: D

Council Tax Band: A (tbc by solicitors).

Tenure: Freehold (tbc by solicitors).

For more information or to arrange a viewing, please call us on 01384 319 400.

How can we help you?

Need a mortgage?

We recommend Wiser Mortgage Advice. They will search the market for you to ensure you get the right lender and mortgage deal. They typically achieve mortgage offers much more quickly than if you were dealing with lenders directly. The initial appointment is free and without obligation. Call us on 01384 319 400, or visit their website for more information: www.wisermortgageadvice.co.uk

Property to sell?

If you need to sell a property in order to buy, you ideally need to be on the market at least (and preferably Sold STC) before viewing, otherwise you may lose out to other buyers when the right property comes along. In these circumstances we can get your property 'live' quickly. Just book a free valuation and we will visit your property and discuss your needs.

Need a solicitor?

A good solicitor can save you literally weeks of time in the buying/selling process, reducing the stress levels of all involved. We will instruct a reputable firm that is competitive on cost and very reliable. Just ask for a quote.

Need a removal company and storage?

A professional removal company takes the stress out of moving. Knowing that your belongings are safe and insured far outweighs any small savings by trying to do it yourself or using a man-and-a-van service. We work closely with and recommend Cube Removals as the leading local firm. For peace of mind and a reliable service call them on 0800 193 0000 or visit their website, cuberemovals.co.uk, to arrange a survey.

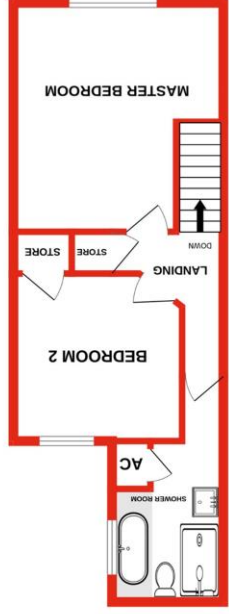
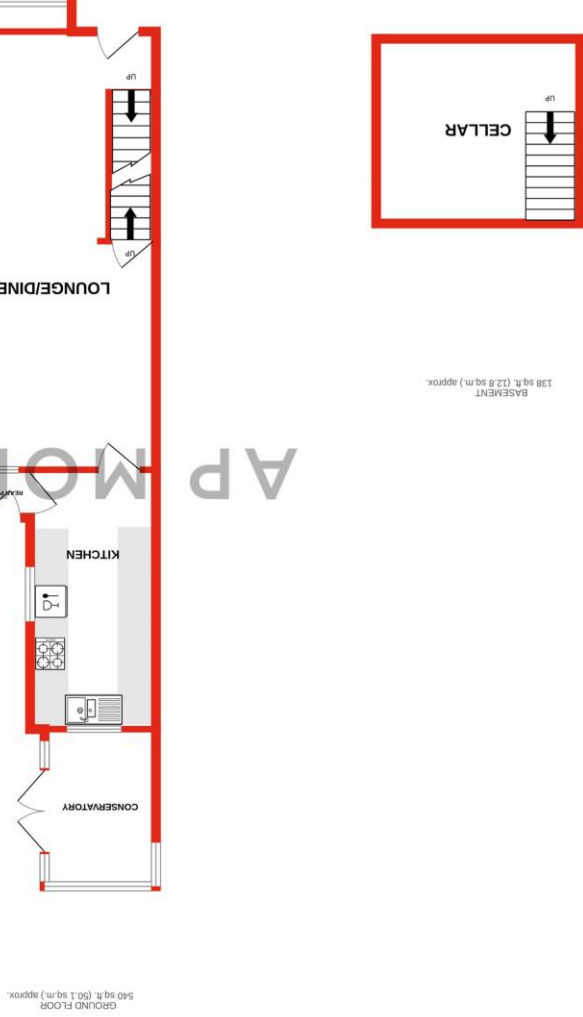

Whilst every attempt has been made to ensure the accuracy of the floorplan contained here, measurements of doors, windows, doors and lay their are approximate and no responsibility is taken for any error, omission or mis-statement. This plan is for illustrative purposes only and should be used as such. By any prospective purchaser. The services, systems and appliances shown have not been tested and no guarantee is made with Metrogix ©2023

AP MORGAN

No statement in these details is to be relied upon as representation of fact, and purchasers should satisfy themselves by inspection or otherwise as to the accuracy of the statements contained within. These details do not constitute any part of any offer or contract. AP Morgan and their employees and agents do not have any authority to give any warranty or representation whatsoever in respect of this property. These details and all statements herein are provided without any responsibility on the part of AP Morgan or the vendors. Equipment: AP Morgan has not tested the equipment or central heating system mentioned in these particulars and the purchasers are advised to satisfy themselves as to the working order and condition. Measurements: Great care is taken when measuring, but measurements should not be relied upon for ordering carpets, equipment, etc. The Laws of Copyright protect this material. AP Morgan is the Owner of the copyright. This property sheet forms part of our database and is protected by the database right and copyright laws. No unauthorised copying or distribution without permission.